

COVER NUT SET, UNC THREAD 316 STAINLESS STEEL

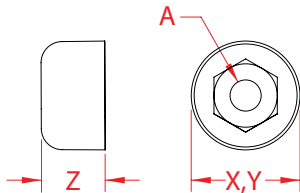

Import



Precision
Machined



Suncor
Exclusive

ITEM	A (size)	X (height)	Y (length)	Z (width)	WT (lb)	PACKAGING TYPE	EACH (qty)	INNER (qty)	CARTON (qty)	UPC
S0307-UN07-L	1/4"	0.75"	0.75"	0.40"	0.04	POLYBAG	1	10	1,000	791506038894
S0307-UN07-R	1/4"	0.75"	0.75"	0.40"	0.04	POLYBAG	1	10	1,000	791506038900

NOTE:
DESIGNED FOR USE WITH HAND SWAGE AND STANDARD STUDS. COVER NUT SET IS PERFECT FOR CABLE RAILING SYSTEMS WHERE "THROUGH POST" HARDWARE IS DESIRED FOR MINIMAL OBSTRUCTION.
AFFIX TO END OF SWAGE STUD FOR A FINISHED LOOK.
ALL DIMENSIONS ARE NOMINAL (+/- 3%) AND ARE SUBJECT TO CHANGE WITHOUT NOTICE.